

## Pro Series Ventilation Service Manual

General Information.....	2
Component Access & Removal.....	4
Troubleshooting Guide.....	19
Test Procedures.....	21
Technical Data.....	22
Wiring Diagrams.....	23



## General Information

### GENERAL INFORMATION

#### SERVICE MANUAL INTRODUCTION

This service manual helps with troubleshooting and diagnosing malfunctions, completion of repairs, and return of the product to proper operating condition. Read the complete instructions contained within before initiating any repairs.

This guide is intended for use by Factory Certified Service. Wolf Appliance, Inc. recommends that only Factory Certified Service companies do repairs.

Warning and Caution product safety labels appear throughout this manual. Product safety labels appear at the beginning of some sections. Follow the instructions in the product safety labels to avoid personal injury and/or product damage. The sample safety labels explain the types of notices that appear in this manual.

#### ⚠ WARNING

**States a hazard that may cause serious injury or death if precautions are not followed.**

#### ⚠ CAUTION

**Indicates minor injury or product damage may occur if precautions are not followed.**

**IMPORTANT NOTE:** Highlights especially important information.

**TIP:** Indicates additional, useful information.

Information and images contained herein are copyright of Wolf Appliance, Inc. Neither this manual nor any information or images contained herein may be copied or used in whole or in part without the express written consent of Wolf Appliance, Inc. © Wolf Appliance, Inc., all rights reserved.

#### WOLF PRO VENTILATION PRODUCT RATING PLATE INFORMATION

On Pro Wall Hoods, the rating plate is located on the left-hand wall.

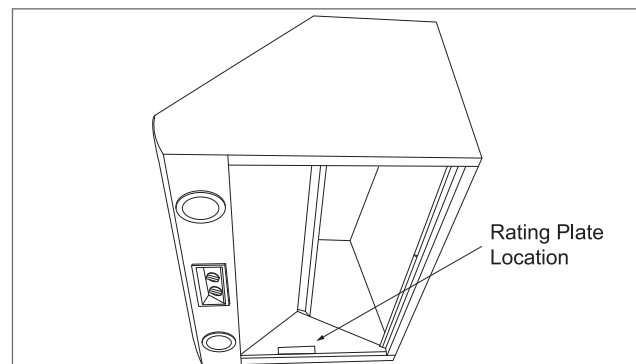

Important information for each product is listed on the product rating plate. Rating plates identify:

- Model
- Serial number
- Electrical information

Wolf Appliance, Inc.  
Fitchburg, WI

VOLTS: 120 AMP: 11.5

HZ: 60 2 WIRE

MODEL # PW302418 SERIAL # XXXXXXXXXX

"Do Not Immerse In Water" "Ne pas plonger dans l'eau"

VENTILATION HOOD  
FOR HOUSEHOLD USE ONLY THERMALLY PROTECTED  
30" MINIMUM FROM COOKING SURFACE TO BOTTOM  
OF VENTILATION HOOD

HOTTE DE VENTILATION  
POUR UTILISATION DOMESTIQUE SEULEMENT PROTEGE  
THERMIQUEMENT 30 POUCES MINIMUM DE LA SURFACE  
DE CUISSON AU FOND DE LA HOTTE DE VENTILATION

MAX WATTAGE 9015349-005  
HEAT LAMP: HALOGEN LAMP: 50 W

#### MODEL DESCRIPTIONS AND SALES ACCESSORIES

For more details on individual model descriptions and a listing of all compatible sales accessories, see the [Wolf Product and Sales Accessory Reference Guide](#).

#### PROFESSIONAL VENTILATION MODEL KEY

Model Character	Description
ICB	International Designation
P	Professional Ventilation
W	Model Type Wall
I	Model Type Island
L	Model Type Liner
WC	Model Type Wall Chimney
24, 30, 36, 40, 42, 46, 48, 52, 54, 58, 60, or 66	Width (in inches)
19, 22, 24, 27, 33, or 34	Depth (in inches)
10, 12, or 18	Height (in inches)
O	Outdoor



### General Information

service.subzero.com

Product Use and Care and Installation Guides (continued)

#### PRODUCT USE AND CARE AND INSTALLATION GUIDES

Product use and care guides, installation guides, and other product specifications are available in the [Product Specifications and Manuals Library](#).

#### UNIT WARRANTY

Product warranty is determined by the installation location and the date of installation.

- View product warranties at <http://service.subzero.com/ClaimsAndOrderProcessing/Pages/WarrantyInfo>.
- Warranties start on the day of product installation.
- Search for warranty and service information by serial number, customer last name, and address using Unit History at <http://service.subzero.com/Tools/UnitHistory>.

## Component Removal and Installation

service.subzero.com

### COMPONENT REMOVAL AND INSTALLATION

#### LIGHTS AND KNOBS

##### Knob Removal

##### Remove the Knob

Pull the knob from the shaft.

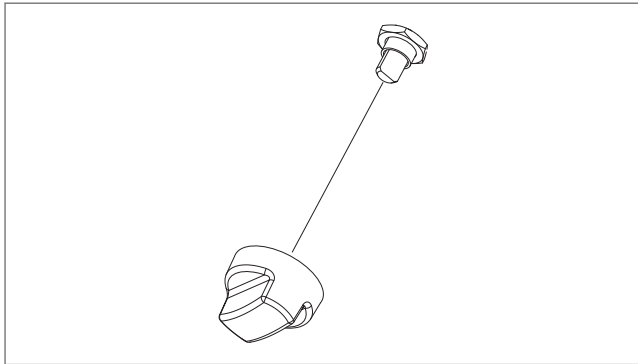

##### Knob Installation

##### Install the Knob

Push the knob onto the shaft.

##### Knob Bezel Removal

To remove the knob bezel, first remove:

- 1 Both *knobs*

##### Remove the Knob Bezel

- 1 Use a  $\frac{1}{2}$ " socket to remove the nuts securing the control shafts to the knob bezel.
- 2 Press the knob bezel toward the rear of the unit to disengage the plastic clips securing the knob bezel.
- 3 Rotate the knob bezel downward.
- 4 Remove the knob bezel from the unit.

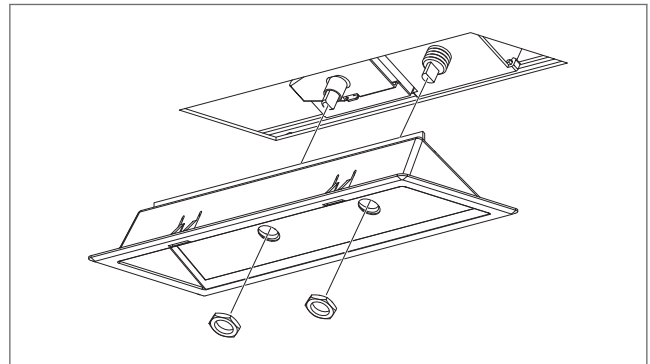

##### Knob Bezel Installation

##### Install the Knob Bezel

- 1 Press the knob bezel into the unit opening so that the control shafts pass through the holes and the knob bezel's plastic clips engage.
- 2 Use a  $\frac{1}{2}$ " socket to install the nuts securing the control shafts to the knob bezel.

## Component Removal and Installation

service.subzero.com

### Halogen Lamp Removal

#### ⚠ WARNING

Disconnect the product from the power source before starting this procedure.

### Remove the Halogen Lamp

- 1 Use a soft cloth or light bulb changer tool to hold the light bulb.
- 2 Rotate the halogen lamp counterclockwise.
- 3 Remove the halogen lamp from the unit.

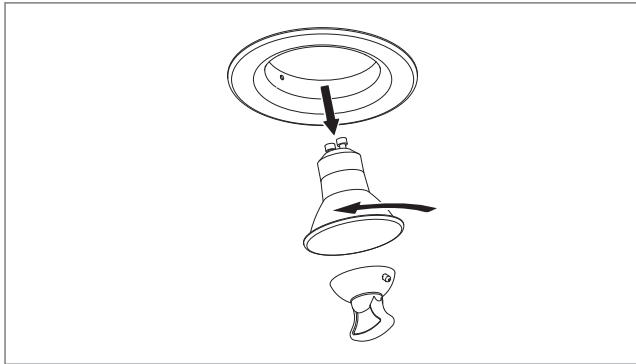

### Halogen Lamp Installation

#### Install the Halogen Lamp

- 1 Insert the halogen lamp into the socket.
- 2 Rotate the halogen lamp clockwise.

### Lamp Bezel Removal

#### ⚠ WARNING

Disconnect the product from the power source before starting this procedure.

To remove the lamp bezel, first remove:

- 1 The appropriate *halogen lamp*

### Remove the Lamp Bezel

- 1 For both springs that hold the lamp bezel to the lamp mount assembly, use needle-nose pliers to pull the spring hook out of the hole in the lamp bezel.
- 2 Remove the lamp bezel from the unit.

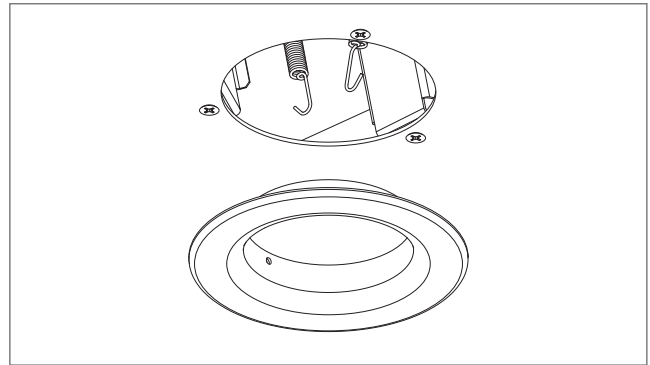

### Lamp Bezel Installation

#### Install the Lamp Bezel

- 1 Insert the lamp bezel into the unit.
- 2 For both springs that hold the lamp bezel to the light mount assembly, use needle-nose pliers to stretch the spring down and insert the hook into the hole in the lamp bezel.

## Component Removal and Installation

service.subzero.com

### Lamp Socket Removal

#### ⚠ WARNING

Disconnect the product from the power source before starting this procedure.

To remove the lamp socket, first remove:

- 1 *Halogen lamp*

### Remove the Lamp Socket

- 1 Use a small Phillips screwdriver to remove the screws from inside the lamp socket.
- 2 Pull the lamp socket down and disconnect the lamp socket wire harness.
- 3 Remove the lamp socket from the unit.

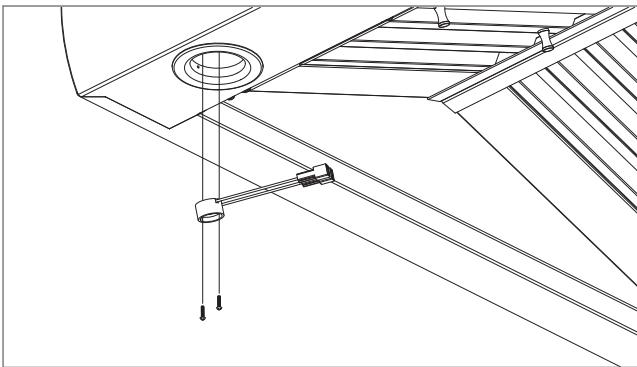

### Lamp Socket Installation

After installing the lamp socket, install:

- 1 *Halogen lamp*

### Install the Lamp Socket

- 1 Connect the lamp socket wire harness.
- 2 Insert the lamp socket wire harness into the hood and place the lamp socket into the lamp frame.
- 3 Use a small Phillips screwdriver to install the screws into the lamp socket.

## Component Removal and Installation

service.subzero.com

Air Capture Area (continued)

### AIR CAPTURE AREA

#### Filter Assembly Removal

##### Remove the Filter Assembly

- 1 Hold the filter assembly by the knobs, and push the filter assembly toward the top of the hood.
- 2 Pull the bottom of the filter assembly toward the center of the hood.
- 3 Pull the filter assembly down.
- 4 Remove the filter assembly from the unit.

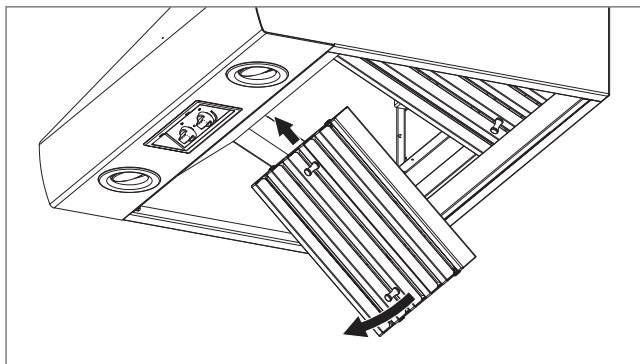

#### Filter Assembly Installation

##### Install the Filter Assembly

- 1 Place the filter assembly into the channel at the top of the hood.
- 2 Push the filter assembly up.
- 3 Push the bottom of the filter assembly toward the lower channel of the hood.
- 4 With the filter assembly over the lower channel, lower the filter assembly down into the grease cup.

#### Side Spacer Removal

To remove the side spacer, first remove:

- 1 All *filter assemblies*

##### Remove the Side Spacer

- 1 Press the side spacer up against the top spring so that it comes free of the bottom spring.
- 2 Move the side spacer inward from the edge, and rotate it downward.
- 3 Remove the side spacer from the unit.

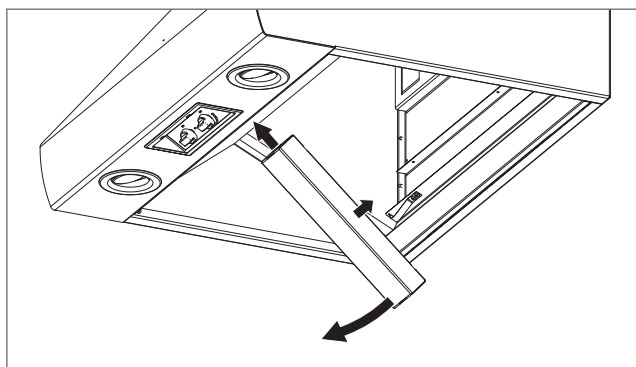

#### Side Spacer Installation

##### Install the Side Spacer

- 1 Place the side spacer into the hood's upper channel.
- 2 Push the side spacer upward, compressing the side spacer against the spring in the channel.
- 3 Rotate the bottom of the side spacer backward into the hood's lower channel.
- 4 Slide the spacer to the edge of the unit.

**TIP:** The spacers are pushed slightly towards the outside wall of the unit.

- 5 Release the side spacer so that it rests over the grease cup.



### Component Removal and Installation

service.subzero.com

#### Grease Cup Removal

To remove the grease cup, first remove:

- 1 All *filter assemblies*
- 2 Both *side spacers* (if present)

#### Remove the Grease Cup

- 1 Lift the grease cup from the lower channel of the hood.
- 2 Remove the grease cup from the unit.

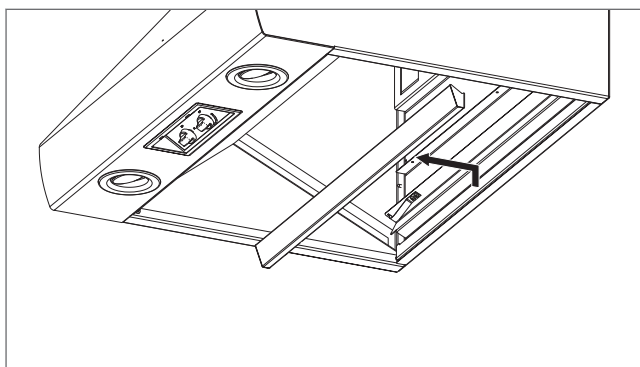

#### Grease Cup Installation

##### Install the Grease Cup

Hang the grease cup on the mounting flange at the rear of the hood.

#### Filter Spring Removal

**TIP:** Filter springs are also used to hold the side spacers in place.

To remove the filter spring, first remove:

- 1 The necessary *filter assembly*
- 2 If applicable, the necessary *side spacer*

#### Remove the Filter Spring

- 1 Use a Phillips screwdriver to remove the two screws.
- 2 Remove the filter spring from the unit.

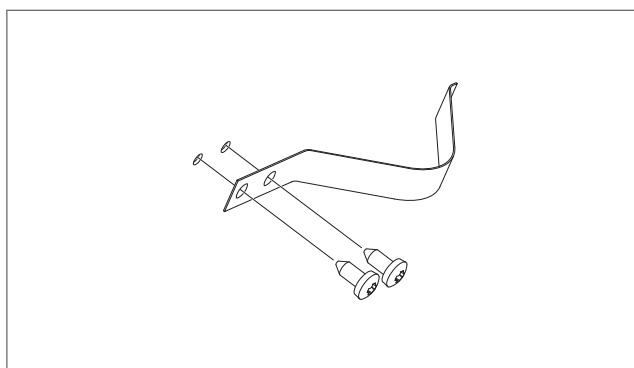

#### Filter Spring Installation

##### Install the Filter Spring

- 1 Place the filter spring over the screw holes in the mounting surface.
- 2 Use a Phillips screwdriver to install the two screws.





### Component Removal and Installation

service.subzero.com

Hood Top and Rear (continued)

#### HOOD TOP AND REAR

##### 10" Transition Removal

To remove the 10" transition, access to the top of the hood is required. This might be from a space above the hood, or the hood may need to be uninstalled.

##### Remove the 10" Damper

- 1 Use a Phillips screwdriver to remove the screws from the damper brackets.
- 2 Slide the damper hold-down brackets away from the damper.
- 3 Remove the 10" damper from the unit.

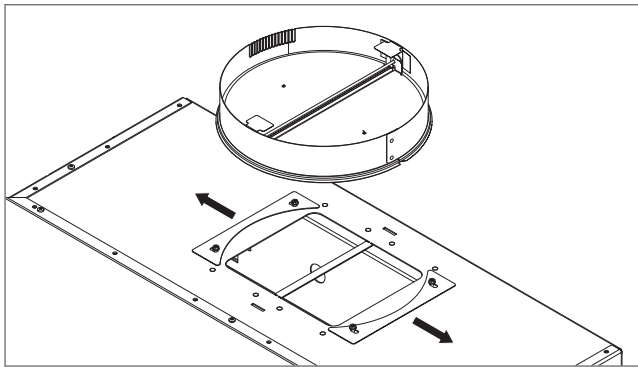

##### 10" Transition Installation

##### Install the 10" Damper

- 1 Place the 10" damper onto the top of the hood.
- 2 Place the damper brackets onto the 10" damper.
- 3 Use a Phillips screwdriver to install the screws into the damper brackets.

##### Rear Panel Assembly Removal

To remove the rear panel assembly, first *uninstall the unit*. Then, remove:

- 1 *10" Transition*

##### Remove the Rear Panel Assembly

- 1 Use a Phillips screwdriver to remove the rear panel assembly mounting screws.

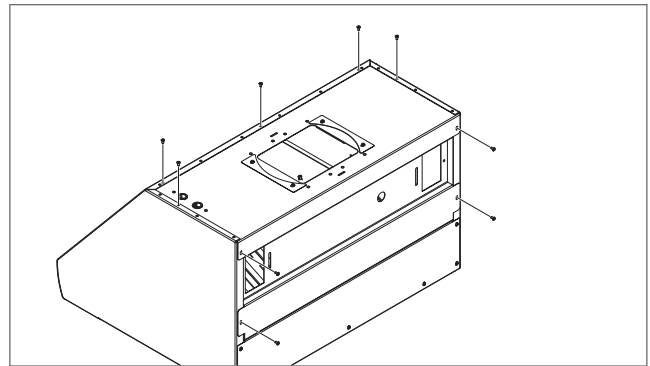

- 2 Pull the rear panel assembly directly backward to remove it from the unit.

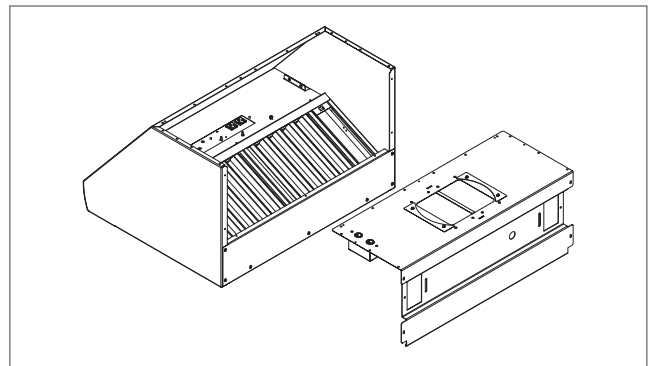

##### Rear Panel Assembly Installation

##### Install the Rear Panel Assembly

- 1 Place the rear panel assembly onto the unit from the rear. The assembly's top should fit under the enclosure front and side panel flanges.
- 2 Use a Phillips screwdriver to install the rear panel assembly mounting screws.

### Component Removal and Installation

service.subzero.com

#### Enclosure Rear Removal

To remove the enclosure rear, first remove:

- 1 All *filter assemblies*
- 2 Both *side spacers* (if present)
- 3 *Grease cup*

Then, *uninstall the unit*.

#### Remove the Enclosure Rear

- 1 Use a Phillips screwdriver to remove the enclosure rear mounting screws.
- 2 Remove the enclosure rear from the unit.

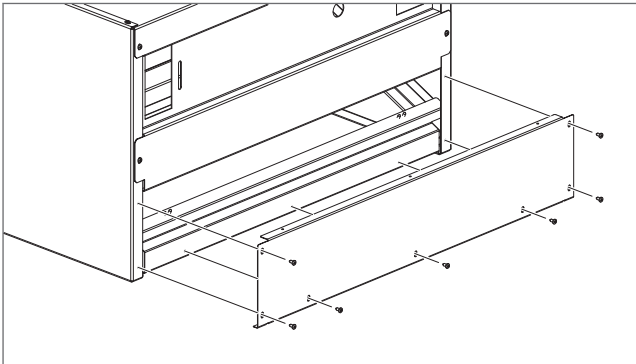

#### Enclosure Rear Installation

##### Install the Enclosure Rear

- 1 Place the enclosure rear onto the unit.
- 2 Use a Phillips screwdriver to install the enclosure rear mounting screws.

## Component Removal and Installation

service.subzero.com

Hood Interior (continued)

### HOOD INTERIOR

#### Sliding the Light Shroud for Interior Access

**TIP:** Removal of the light shroud is not recommended due to danger of scratching the surrounding stainless steel parts. Instead, it is possible to slide the light shroud backward in its channel to allow access to the hood electronics.

To slide the light shroud for interior access, first remove:

- 1 All *filter assemblies*
- 2 Both *side spacers* (if present)
- 3 *Grease cup*

#### Slide the Light Shroud Backward

- 1 Use a Phillips screwdriver to remove the light shroud screws.

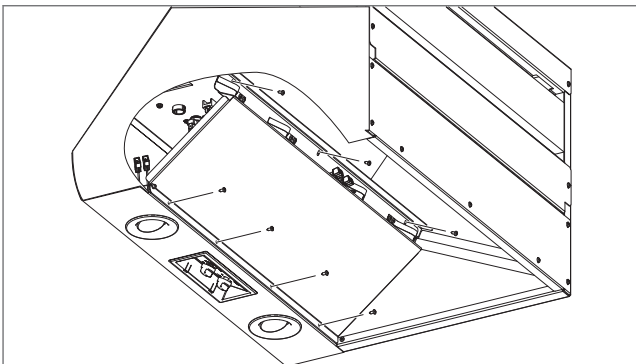

- 2 Slide the light shroud down along the rear channel until it comes to rest.

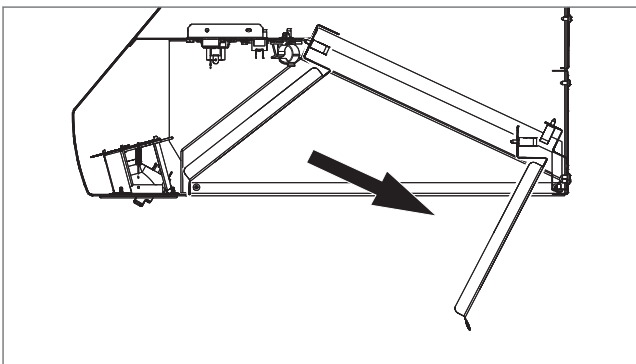

#### Repositioning the Light Shroud After Repair

#### Slide the Light Shroud Forward

- 1 Slide the light shroud along the channel until it comes to rest.
- 2 Use a Phillips screwdriver to install the light shroud screws.

## Component Removal and Installation

service.subzero.com

### Heat Sensor Removal

#### ⚠ WARNING

Disconnect the product from the power source before starting this procedure.

To remove the heat sensor, first remove:

- 1 All *filter assemblies*
- 2 Both *side spacers* (if present)
- 3 *Grease cup*

Then, *rotate the light shroud for access to the hood interior.*

### Remove the Thermal Limiter

- 1 Disconnect the thermal limiter wire connectors.
- 2 Use a Phillips screwdriver to remove the thermal limiter mounting screws.
- 3 Remove the thermal limiter from the unit.

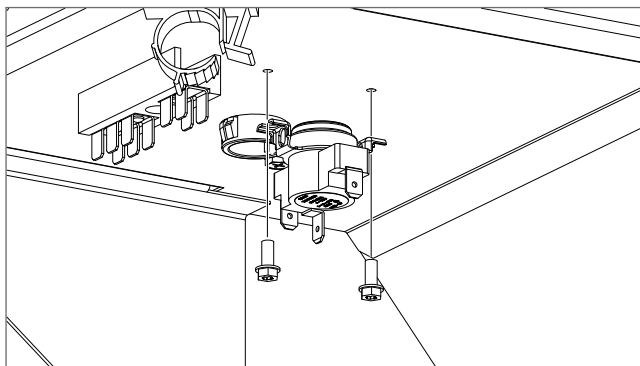

### Heat Sensor Installation

#### Install the Thermal Limiter

- 1 Place the thermal limiter onto the inner panel.
- 2 Use a Phillips screwdriver to install the thermal limiter mounting screws.
- 3 Connect the thermal limiter wire connectors.

### Terminal Block Removal

#### ⚠ WARNING

Disconnect the product from the power source before starting this procedure.

To remove the terminal block, first remove:

- 1 All *filter assemblies*
- 2 Both *side spacers* (if present)
- 3 *Grease cup*

Then, *rotate the light shroud for access to the hood interior.*

### Remove the Terminal Block

- 1 Disconnect the electrical connections from the terminal block.

**TIP:** Photograph or diagram the connections before disconnecting.

- 2 Use a Phillips screwdriver to remove the terminal block mounting screw.
- 3 Remove the terminal block from the unit.

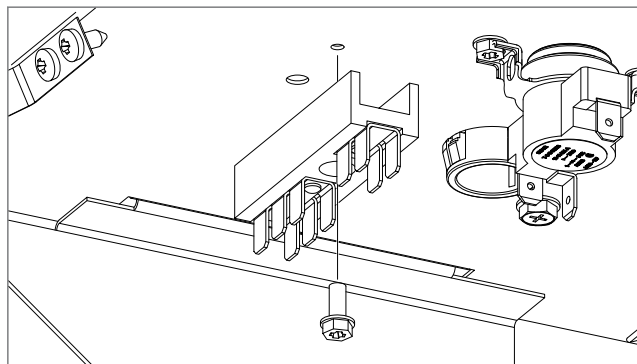

### Terminal Block Installation

#### Install the Terminal Block

- 1 Place the terminal block over the mounting screw hole.
- 2 Use a Phillips screwdriver to install the terminal block mounting screw.
- 3 Connect the electrical connections to the terminal block.

## Component Removal and Installation

service.subzero.com

### Light Shroud Removal

**TIP:** Removal of the light shroud is not recommended due to danger of scratching the surrounding stainless steel parts. Instead, it is possible to *move the light shroud upward in its channel and rotate it* to allow access to the hood electronics.

To remove the light shroud, first remove:

- 1 All *filter assemblies*
- 2 Both *side spacers* (if present)
- 3 *Grease cup*

### Remove the Light Shroud

- 1 Use a Phillips screwdriver to remove the light shroud screws.

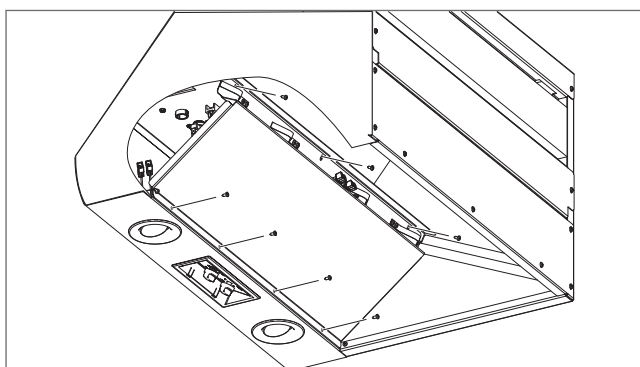

- 2 Pull the light shroud upward along the channel until it is free to rotate downward.
- 3 Rotate the light shroud downward until it is no longer blocked by the side supports.
- 4 Remove the light shroud from the unit.

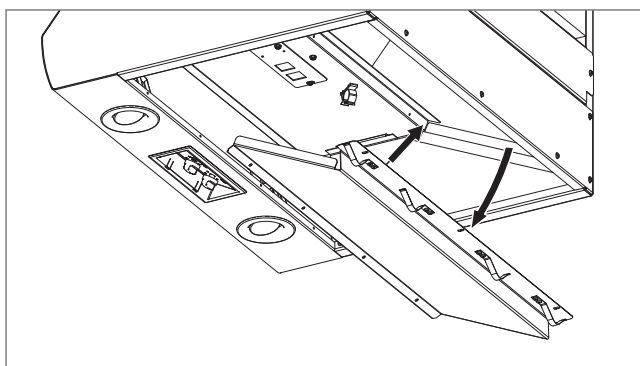

### Light Shroud Installation

#### Install the Light Shroud

- 1 Rotate the light shroud so that its bottom will enter the top channel first.
- 2 Place the light shroud into the unit.
- 3 Rotate the light shroud upward until it is no longer blocked by the side supports.
- 4 Slide the light shroud downward along the channel until it stops.
- 5 Use a Phillips screwdriver to install the light shroud screws.

## Component Removal and Installation

service.subzero.com

### Lamp Assembly Removal

#### ⚠ WARNING

Disconnect the product from the power source before starting this procedure.

To remove the lamp assembly, first remove:

- 1 The appropriate *halogen lamp*
- 2 The appropriate *lamp bezel*
- 3 All *filter assemblies*
- 4 Both *side spacers* (if present)
- 5 *Grease cup*

Then, *rotate the light shroud for access to the hood interior.*

### Remove the Light Mount Assembly

- 1 Use needle-nose pliers to disconnect the light mount assembly electrical connections.
- 2 Use a Phillips screwdriver to remove the light mount assembly mounting screws.
- 3 Remove the light mount assembly from the unit.

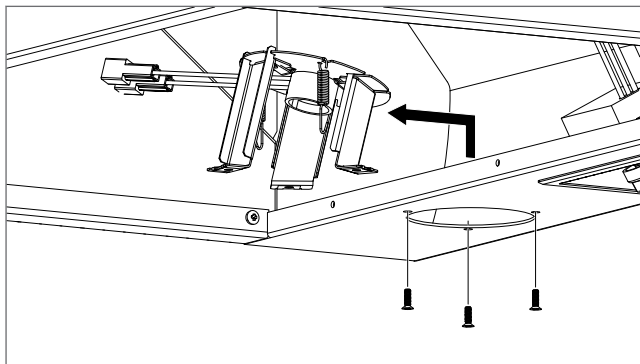

### Lamp Assembly Installation

#### Install the Light Mount Assembly

- 1 Place the light mount assembly into the unit.
- 2 Use a Phillips screwdriver to install the light mount assembly mounting screws.
- 3 Connect the light mount assembly electrical connections.

### Lamp Control Assembly Removal

#### ⚠ WARNING

Disconnect the product from the power source before starting this procedure.

To remove the lamp control assembly, first remove:

- 1 Both *knobs*
- 2 *Knob bezel*

### Remove the Lamp Control Assembly

- 1 Disconnect the lamp control assembly electrical connections.
- 2 Use a 1/2" socket to remove the nut from the lamp control shaft.
- 3 Remove the lamp control assembly from the bezel.

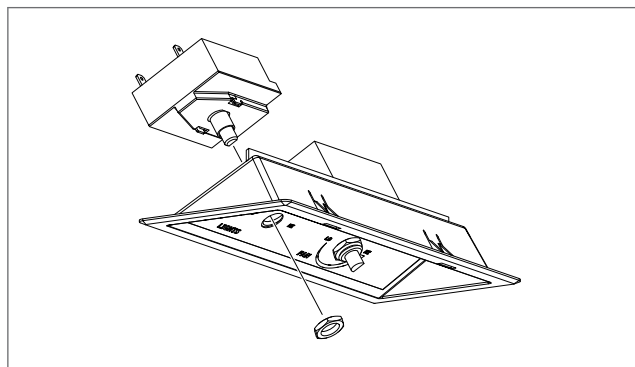

### Lamp Control Assembly Installation

#### Install the Lamp Control Assembly

- 1 Place the lamp control assembly into the bezel.
- 2 Use a 1/2" socket to install the nut onto the lamp control shaft.
- 3 Connect the lamp control assembly electrical connections.

## Component Removal and Installation

service.subzero.com

### Diode Removal

#### ⚠ WARNING

Disconnect the product from the power source before starting this procedure.

To remove the diode, first remove:

- 1 All *filter assemblies*
- 2 Both *side spacers* (if present)
- 3 *Grease cup*

Then, *rotate the light shroud for access to the hood interior.*

### Remove the Diode

Remove the diode from the lamp control assembly.

**TIP:** Note the diode's orientation.

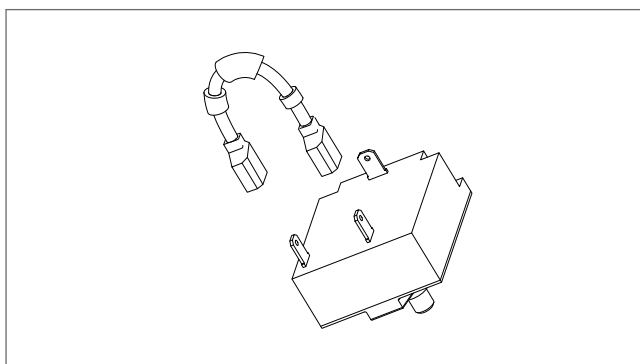

### Diode Installation

#### Install the Diode

Connect the diode to the lamp control assembly.

#### ⚠ CAUTION

Be sure to observe the correct polarity.

### Blower Speed Control Removal

#### ⚠ WARNING

Disconnect the product from the power source before starting this procedure.

To remove the blower speed control, first remove:

- 1 The blower speed control *knob*
- 2 All *filter assemblies*
- 3 Both *side spacers* (if present)
- 4 *Grease cup*

### Remove the Blower Speed Control

- 1 Disconnect the wire connector from the blower switch.
- 2 Use a 1/2" socket to remove the nut from the blower speed control shaft.
- 3 Push the blower speed control up into the hood.
- 4 Remove the blower speed control from the unit.

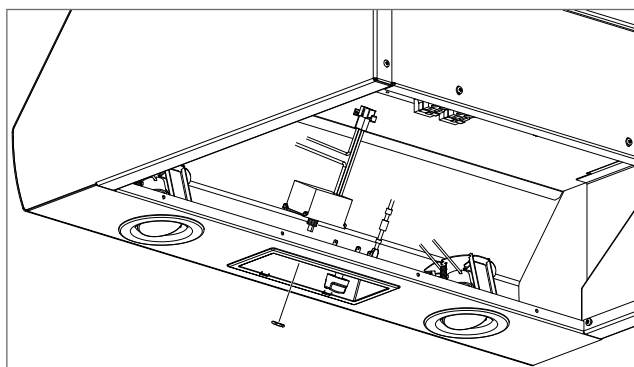

### Blower Speed Control Installation

After installing the blower speed control, install:

- 1 *Inner panel*
- 2 *Internal frame*
- 3 *Grease cup*
- 4 *Filter assembly*

### Install the Blower Speed Control

- 1 Insert the blower speed control into the hood.
- 2 Use a 1/2" socket to install the nut onto the blower speed control shaft.
- 3 Connect the wire connector from the blower switch to the blower speed control.

## Component Removal and Installation

service.subzero.com

### Blower Switch Removal

#### ⚠ WARNING

Disconnect the product from the power source before starting this procedure.

To remove the blower switch, first remove:

- 1 All *filter assemblies*
- 2 Both *side spacers* (if present)
- 3 *Grease cup*

Then, *rotate the light shroud for access to the hood interior.*

### Remove the Blower Switch

- 1 Disconnect the blower switch wire connector.
- 2 Use a T-15 Torx bit to remove the blower switch mounting screws.
- 3 Remove the blower switch from the unit.

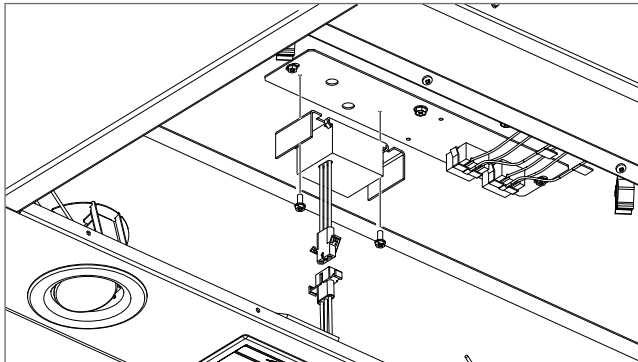

### Blower Switch Installation

#### Install the Blower Switch

- 1 Insert the blower switch into the unit.
- 2 Use a T-15 Torx bit to install the blower switch mounting screws.
- 3 Connect the blower switch wire connector.

### Blower Plug Socket Removal

#### ⚠ WARNING

Disconnect the product from the power source before starting this procedure.

To remove the blower plug socket, first remove:

- 1 All *filter assemblies*
- 2 Both *side spacers* (if present)
- 3 *Grease cup*

Then, *Rotate the light shroud for access to the hood interior.*

### Remove the Blower Plug Socket

- 1 Use a  $\frac{5}{16}$ " socket to remove the blower plug socket ground screw.
- 2 Disconnect the electrical connections from the blower plug socket.

**TIP:** Photograph or diagram the connections before disconnecting.

- 3 Press in the tabs on the side of the blower plug socket. Push the blower plug socket through the inner panel.
- 4 Remove the blower plug socket from the unit.

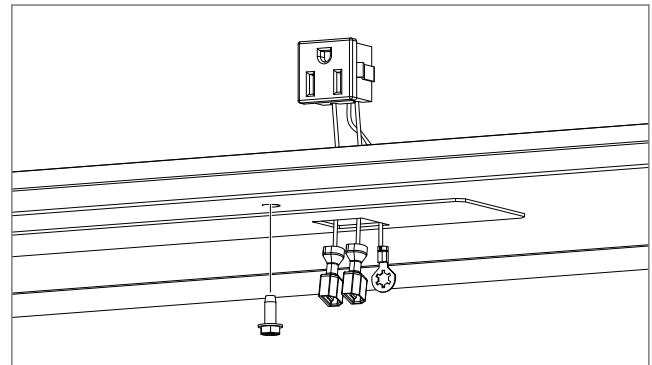

### Blower Plug Socket Installation

#### Install the Blower Plug Socket

- 1 Insert the blower plug socket into the inner panel.
- 2 Connect the electrical connections to the blower receptacle.
- 3 Use a  $\frac{5}{16}$ " socket to install the blower plug socket ground screw.



## Component Removal and Installation

service.subzero.com

### Heat Sensor Removal

#### ⚠ WARNING

Disconnect the product from the power source before starting this procedure.

To remove the heat sensor, first remove:

- 1 All *filter assemblies*
- 2 Both *side spacers* (if present)
- 3 *Grease cup*

Then, *rotate the light shroud for access to the hood interior.*

### Remove the Thermal Limiter

- 1 Disconnect the thermal limiter wire connectors.
- 2 Use a Phillips screwdriver to remove the thermal limiter mounting screws.
- 3 Remove the thermal limiter from the unit.

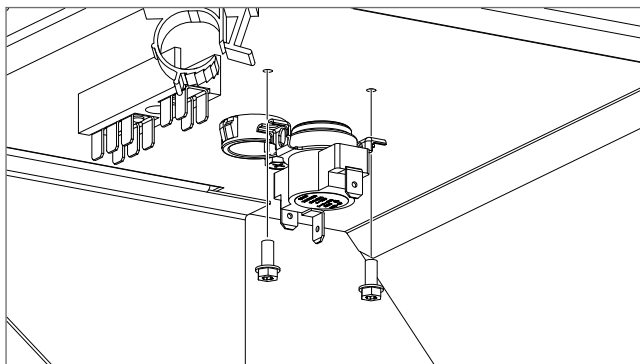

### Heat Sensor Installation

#### Install the Thermal Limiter

- 1 Place the thermal limiter onto the inner panel.
- 2 Use a Phillips screwdriver to install the thermal limiter mounting screws.
- 3 Connect the thermal limiter wire connectors.

### Terminal Block Removal

#### ⚠ WARNING

Disconnect the product from the power source before starting this procedure.

To remove the terminal block, first remove:

- 1 All *filter assemblies*
- 2 Both *side spacers* (if present)
- 3 *Grease cup*

Then, *rotate the light shroud for access to the hood interior.*

### Remove the Terminal Block

- 1 Disconnect the electrical connections from the terminal block.

**TIP:** Photograph or diagram the connections before disconnecting.

- 2 Use a Phillips screwdriver to remove the terminal block mounting screw.
- 3 Remove the terminal block from the unit.

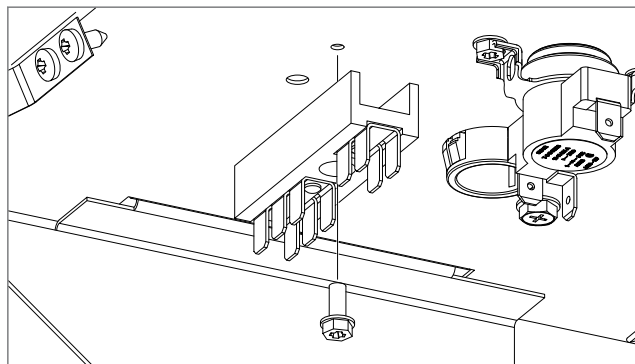

### Terminal Block Installation

#### Install the Terminal Block

- 1 Place the terminal block over the mounting screw hole.
- 2 Use a Phillips screwdriver to install the terminal block mounting screw.
- 3 Connect the electrical connections to the terminal block.

## Component Removal and Installation

service.subzero.com

### Junction Box Removal

#### ⚠ WARNING

**Disconnect the product from the power source before starting this procedure.**

To remove the junction box, first remove:

- 1 All *filter assemblies*
- 2 Both *side spacers* (if present)
- 3 *Grease cup*

Then, *rotate the light shroud for access to the hood interior.*

### Remove the Junction Box

- 1 Use a  $\frac{3}{8}$ " socket to remove the junction box mounting nuts.
- 2 Disconnect the electrical connections inside the junction box.
- 3 Remove the junction box from the unit.

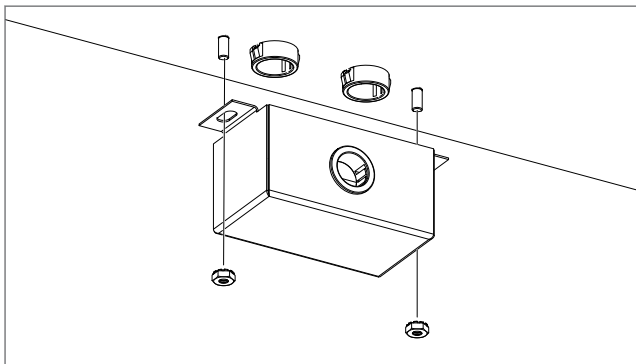

### Junction Box Installation

#### Install the Junction Box

- 1 Place the junction box into the unit.
- 2 Connect the electrical connections inside the junction box.
- 3 Use a  $\frac{3}{8}$ " socket to install the junction box mounting nuts.



### Troubleshooting Guide Pro Wall Hood

service.subzero.com

#### TROUBLESHOOTING GUIDE PRO WALL HOOD

This section explains how to troubleshoot various components in a Wolf Pro Wall Hood.

##### WARNING

To avoid electric shock, disconnect power to the hood when preparing for tests. Care should be used while doing any test with the hood energized.

##### WARNING

The hood is heavy and is lowered from the installation when being uninstalled.



### PRO WALL HOOD TROUBLESHOOTING TABLE

Symptom	Possible Cause or Diagnostic Test	Resolution
Hood lights and blower do not turn on.	The breaker is open.	Reset the breaker.
	GFCI circuit is tripped.	The unit is not recommended for use with a GFCI circuit. Change the outlet type.
	Verify the house circuit is dedicated, the correct voltage, and sized correctly.	If necessary, contact an electrician to bring the circuit into specification. Confirm that the L1, N, and ground are correctly connected. Make sure the connections are tight.
Blower motor runs only at high speed.	Heat sensor closed.	Confirm heat sensor is closed.
	Blower speed control potentiometer problem.	Check for voltage changes out of the blower speed control.
Hood lights do not work.	Test the operation of the halogen lamp.	If only one halogen lamp is out, <a href="#">replace the halogen lamp</a> .
	Disconnect the wire connectors from the light switch and measure the resistance.	If there is no continuity in either the on or off position, replace the light switch.
	Disconnect the electrical supply wire to the light switch and check for the correct voltage.	If there is no voltage, trace the wire to the issue and repair the wire.
Blower motor does not run at any speed.	Internal blowers: Check the voltage at the blower plug socket connector while the blower is running.	Check L1 to ground, L2 to ground, and L1 to L2 for the correct voltage.
	Disconnect the wire connectors from the blower switch and measure the resistance.	If there is no continuity in either the on or off position, replace the blower switch.
	Disconnect the electrical supply wire to the blower switch and check for the correct voltage.	If no voltage, trace the wire to the issue and repair the wire.
	Test the resistance of the blower speed control.	The resistance of the blower speed control should change as the knob is turned. The resistance should never be infinite or open.
	Check the blower.	Replace the blower.
Blower motor runs, but does not change speeds (not at high speed).	<ul style="list-style-type: none"><li>Blower speed control failure</li><li>Wrong voltage supplied to the hood</li></ul>	<ol style="list-style-type: none"><li><a href="#">Check the voltage to the hood at the wiring box.</a></li><li>Check the blower speed control voltage. Back-pin the black to orange wire connector and check between it and ground. The voltage should change as the knob is turned.</li></ol>
Blower comes on by itself.	Heat sensor is closing.	<ul style="list-style-type: none"><li>Hood is too close to cooking equipment.</li><li>Cooking equipment producing too much heat.</li><li>Blower issue.</li><li>Ducting issue.</li><li>Heat sensor failure.</li></ul>
Hood does not move enough air.	Verify the duct run is the correct size, including: <ul style="list-style-type: none"><li>Wall/roof cap is correct.</li><li>No reduction in size at any point.</li><li>Damper is installed correctly.</li><li>No excessive elbows.</li><li>No excessive length.</li><li>No air box used.</li></ul>	Correct the duct issue. Recommended duct size is 10". If necessary, contact an HVAC contractor.
	Blower motor is not changing speeds.	See " <a href="#">Blower motor runs only at high speed</a> " or " <a href="#">Blower motor runs, but does not change speeds.</a> "
	Filters are dirty.	<a href="#">Remove the filters</a> to test. Clean the filters.



### Test Procedures

service.subzero.com

#### TEST PROCEDURES

##### TEST THE LINE VOLTAGE IN THE WIRING BOX

###### **⚠ WARNING**

**Components are energized during these tests. Use extreme caution to prevent electrical shock or shorting out the unit.**

- 1 Disconnect the wire connectors from the home power supply.
- 2 Measure the voltage from the electrical supply L1 (typically black) to ground. The voltage should be 110 VAC to 127 VAC.
- 3 Measure the voltage from the electrical supply neutral (typically white) to ground. The voltage should be 0 VAC.
- 4 Measure the resistance from the electrical supply ground (typically green) to ground. The resistance should be 0  $\Omega$ .
- 5 Measure the voltage from the electrical supply L1 to neutral. The voltage should be 110 VAC to 127 VAC.

##### TEST THE LINE VOLTAGE AT THE BLOWER PLUG SOCKET

###### **⚠ WARNING**

**Components are energized during these tests. Use extreme caution to prevent electrical shock or shorting out the unit.**

- 1 On the blower plug socket side of the wire connector, back-pin the black and white wires as described below, with the blower running on high.
- 2 Measure the voltage from the black wire to the ground. The voltage should be 110 VAC to 127 VAC.
- 3 Measure the voltage from the white wire to the ground. The voltage should be 0 VAC.
- 4 Measure the resistance between the ground to a unit ground. The resistance should be 0  $\Omega$ .
- 5 Measure the voltage from the black wire to the white wire. The voltage should be 110 VAC to 127 VAC.

##### TEST THE INTERNAL BLOWER

Do these tests only after confirming the voltage is correct up to the internal blower.

- 1 Unplug the internal blower plug.
- 2 On the blower plug, measure the resistance from pin L1 to neutral.
- 3 Measure the resistance from the plug L1 to the blower casing.
- 4 Measure the resistance from the plug neutral to the blower casing.
- 5 If the reading is open from L1 to neutral or there is continuity from L1 or neutral to the blower case, replace the blower.



### Technical Data

service.subzero.com

#### TECHNICAL DATA

#### PRO WALL HOOD TECHNICAL DATA

PRO WALL HOOD TECHNICAL DATA	
Parameter	Value
AC power	110 VAC to 127 VAC
Blower speed control 812511	120 VAC, 7 A (Max)
Heat sensor 811193	Current rating: 25 A at 120 VAC Opens at 200° ± 5°F, closes at 185° ± 5°F



## Wiring Diagrams

service.subzero.com

### WIRING DIAGRAMS

#### PRO VENTILATION ENHANCEMENTS WIRING DIAGRAMS

## WIRING DIAGRAM MODELS: ALL 24" & 22" PRO WALL HOODS

PART NUMBER 820550 Rev A

PLACE IN WIRING DIAGRAM BAG FOR FUTURE REFERENCE

### WARNING

- This wiring information is provided for use by qualified service personnel only.
- Disconnect appliance from electrical supply before beginning service.
- Be sure all grounding devices are connected when service is complete.
- Failure to observe the above warnings may result in severe electrical shock.

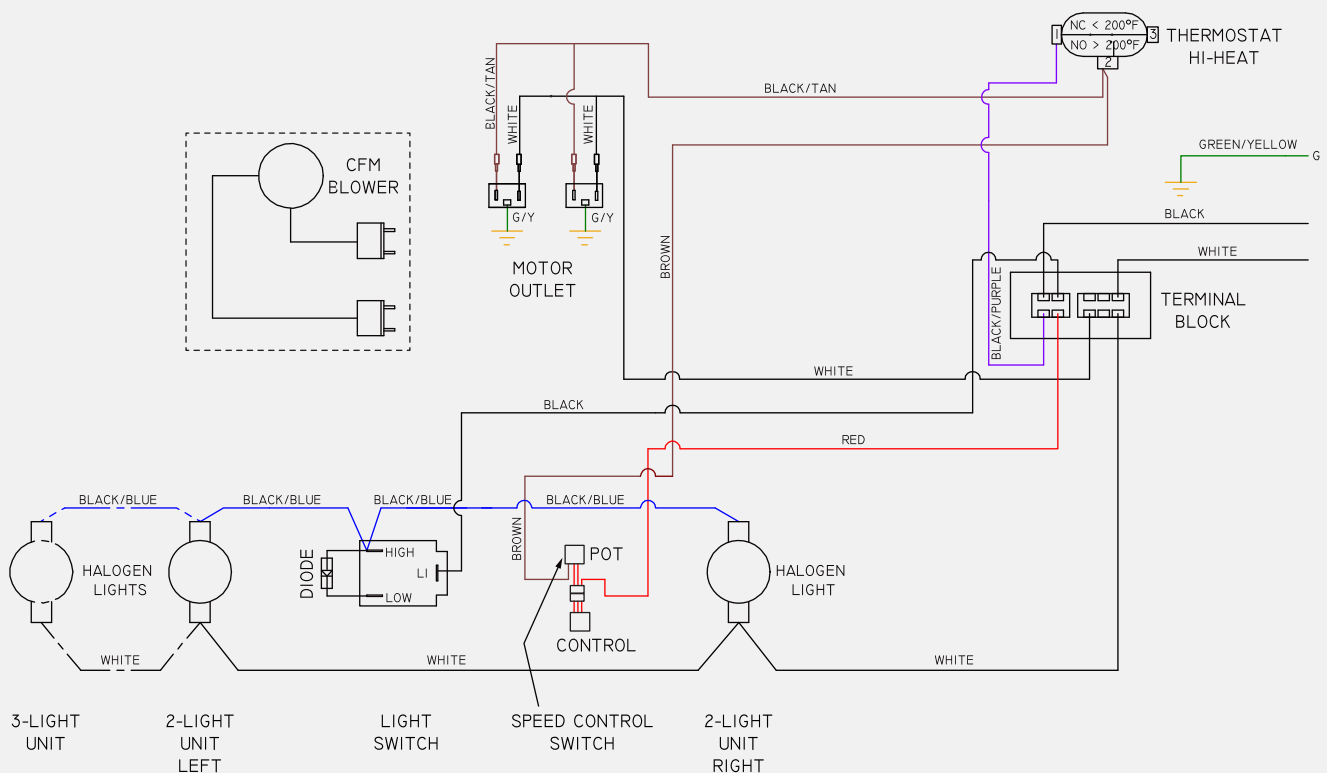

— TYPICAL OF BOTH 2 AND 3 LIGHT UNITS  
- - - 3- LIGHT UNIT ONLY